

SERV-OIL Multiple-Point Injection Lubricators

Series 710, 720



Model Shown: 71003104B

Up to 10 Servo-Meters can be assembled to make up a multiple point lubricator (MPL). Assembled MPLs can be ordered, or they can be assembled by the user employing the Servo-Meter and Assembly/Mounting Kits shown on the facing page. Master Pneumatic recommends that you order factory-assembled MPLs. The cost is economical, your installation time is greatly reduced, and you are assured of reliable performance because both the components and the assemblies have been factory-tested.

The frequency of oil injection can be controlled by using one of the pulse counters or frequency controllers detailed on page 200.

Series 710 factory assemblies employ two mounting holes. When a very rigid mounting is needed, order Series 720 which employs heavy-duty mounting plates with four mounting holes.

SPECIFICATIONS

Ambient/Media Temperature:

40° to 125°F (4° to 52°C).

Controller: See page 200 for the various types of controllers available.

Operating Pressure: 60-150 psig (4.1-10.3 bar).

Reservoir: See page 222 for the various types of reservoirs available.

Servo-Meter: Brass body; optional Aluminum and Nickel plated housings; acetal end caps. 1-Drop rating; optional 1/2-drop or 2-drop rating. Minimum operating air pressure: 60 psig (4 bar).

Oil Viscosity Range: 31-1000 @ 100°F (37.8°C)

FLU-TECH CO. LTD.

Email: sales@flutech.co.th **Website:** <https://flutech.co.th>

Tel: 02-384-6060, 086-369-5871-3 **Fax:** 02-384-5701 **LINE OA:** @flutech.co.th

Address (HQ): 845/3-4, Moo 3, Theparak Rd., T. Theparak, A. Mueang Samut Prakan, Samut Prakan, 10270, Thailand

LINE OA WEBSITE



DIMENSIONS inches (mm)

A	B †	C	D	E †
3.9 (99)	2.5 (64)	1.8 (46)	4.1 (104)	4.3 (109)

† Add 0.9 (23) for each additional Servo-Meter.

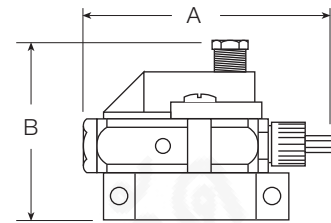
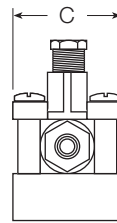

Without Pulse Counter

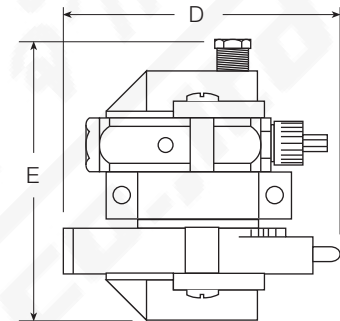
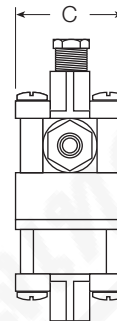

With Pulse Counter

ORDERING INFORMATION

Change the letters in the sample model number below to specify the MPL you want.

710 01 05 4 B - Y W

MPL SERIES

Standard MPL assembly..... 710
MPL assembly with heavy-duty mount..... 720

NUMBER OF SERVO-METERS

Specify by numerals
from 01 to 10

SERVO-METER RATING

Half drop 05
One drop 10
Two drops 20

SERVO-METER HOUSING MATERIAL

Brass housing B
Aluminum housing A
Nickel plated brass housing, N
clamp and mounting plate.

PORT TYPE

NPTF threads Leave Blank
BSPP threads W

OPTIONS (More than one option can be chosen. Add in alphabetical order)

None Leave Blank
Servo-Meter shutoff A
Non-shutoff Leave Blank
Block plate; indicate position
from top with * B*
Pulse counter
One C
Two CC
Oil End Seals (Buna N standard)
EPR E
Neoprene N
Viton V
Frequency controller F
and one pulse counter
Frequency controller only F1

AUTHORIZED DISTRIBUTOR



บริษัท ฟลูเทค จำกัด
FLU-TECH Co.,LTD.

LINE @flutech.co.th

0 2384 6060

www.flutech.co.th

sales@flutech.co.th