

## Liquid Dispensers

## Series 740, 770



Model Shown: 74004204B-ALV

### SPECIFICATIONS

**Ambient/Media Temperature:**

40° to 125°F (4° to 52°C).

**Inlet Pressure:** 60 to 120 psig (4 to 8 bar).

**On/Off Control:** Manual.

**Servo-Meter Body:** Brass Body; optional Aluminum and Nickel plated brass; zinc end plates.

**Servo-Meter Seals:**

Nitrile on air end; viton on oil end.

The Series 740 liquid dispenser employs Servo-Meters to send precise amounts of liquid through nozzles. It is primarily used where liquid without entrained air is wanted, and a precisely controlled jet is not required. Up to 10 Servo-Meters can be used in a single assembly. A pressure of at least 60 psig (4 bar) is required for actuation.

1/8-Inch O.D. nylon tubing carries the oil from a Servo-Meter to a nozzle [5/64" (2-mm) orifice] located near the delivery point.

**Install a liquid-only dispenser so that the Servo-Meters are vertical and the outlets are at the top.** This helps to eliminate air from the system. The nozzles need to be secured in place with a clamp or similar means.

Series 740 factory assemblies employ two mounting holes. When a very rigid mounting is needed, order Series 770 which employs heavy-duty mounting plates with four mounting holes.

Liquid dispenser assemblies can be ordered, or they can be assembled by the user employing the Servo-Meter and Assembly/Mounting Kits shown on the facing page.

*Master Pneumatic recommends that you order factory-assembled dispensers. The cost is economical, your installation time is greatly reduced, and you are assured of reliable performance because both the components and the assemblies will have been factory-tested.*

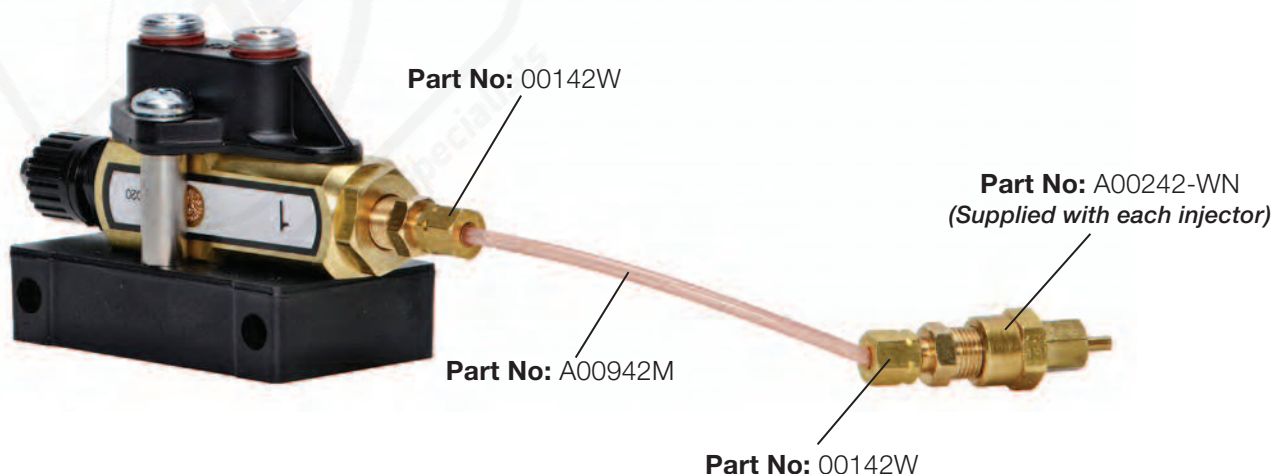

**DIMENSIONS** inches (mm)

A	B †	C
3.9 (99)	2.5 (64)	1.8 (46)

† Add 0.9 (23) for each additional Servo-Meter.

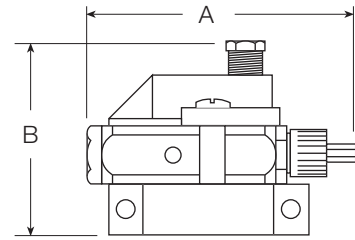
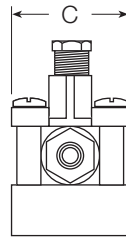

**LIQUID DISPENSER ASSEMBLY KITS**

Mounting/Assembly Kit KA474-10

Mounting/Assembly Kit

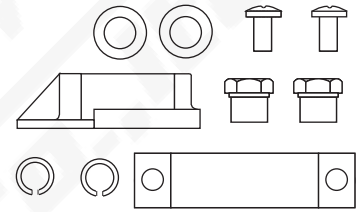

**ORDERING INFORMATION**

Change the letters in the sample model number below to specify the Liquid Dispenser you want.

**740 01 05 4 B - Y L V W**

**LIQUID EJECTOR SERIES**

Assembly with standard mount ..... 740  
 Assembly with heavy-duty mount..... 770

**NUMBER OF SERVO-METERS**

Specify by numerals from 01 to 10

**SERVO-METER RATING**

Half drop ..... 05  
 One drop ..... 10  
 Two drops ..... 20

**SERVO-METER HOUSING MATERIAL**

Brass housing ..... B  
 Aluminum housing ..... A  
 Nickel plated brass housing, ..... N  
 clamp and mounting plate.

**PORT TYPE**

NPTF threads ..... Leave Blank  
 BSPP threads ..... W

**OPTION**

Oil end seals for Servo-Meter  
 Viton ..... V  
 EPR ..... Leave Blank  
 (Add E using other option Location)

**OPTIONS** (More than one option can be chosen. Add in alphabetical order)

None ..... Leave Blank  
 Servo-Meter shutoff ..... A  
 Non-shutoff ..... Leave Blank  
 Pulse counters  
 One ..... C  
 Two ..... CC  
 Oil End Seals for Servo-Meter  
 EPR ..... E  
 Frequency controller ..... F  
 and one pulse counter  
 Frequency controller only ..... F1

Liquid Dispensers 740 and 770 Series