

LEVEL COMPENSATORS

Range of compensators with external or internal spring. Anti-rotation version is available to guarantee maximum precision and reliability in positioning.



Criteria of choice and functionality

This accessory makes it possible to overcome differences in height that may be found in various applications, for example in lifting systems where the suction cups are fixed to a rigid structure or when a suction cup is used on the arm of an anthropomorphic robot or in a similar system where the items must be accurately positioned at the required height; in addition, the device makes it possible, within certain limits, to absorb pushback.

The Pneumax range is subdivided into three types:

- **Compensator with external spring**
- **Compensator with internal spring**
- **Anti-rotation compensator with internal spring**

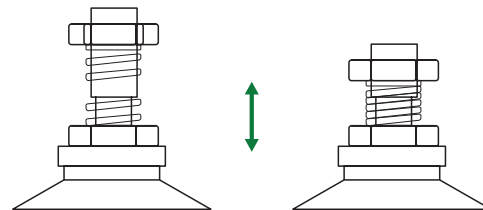

Series 1900

Standard level compensator M5 - internal spring

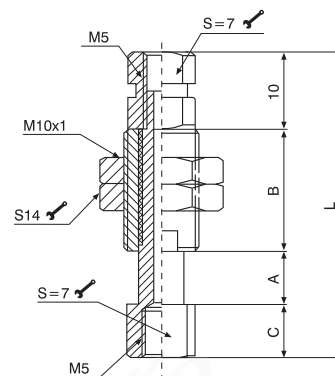

Code	A	B	C	L	Weight (gr.)
19P05.S.07.I	7	19	7	43	18.7
19P05.S.15.I	15	23	27	75	28.2
19P05.S.20.I	20	36	7	73	28.8

The standard level compensator M5 makes it possible to compensate for differences in height when the gripping system has to deal with objects of different heights, simplifies accurate positioning on vacuum systems, and makes it possible to position the suction cups on fragile items.

Standard level compensator G1/8" – internal and external spring

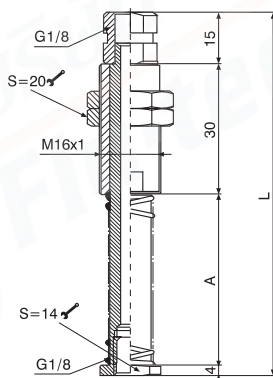

Code	A	L	Weight (gr.)
19P18.S.10.E	20	69	85
19P18.S.20.E	35	84	98
19P18.S.30.E	50	99	111.5
19P18.S.50.E	70	119	123.3

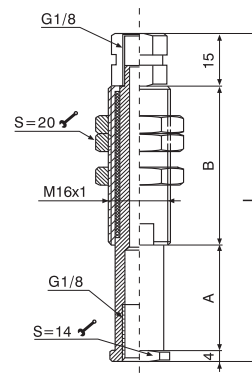

Code	A	B	L	Weight (gr.)
19P18.S.10.I	10	25	54	59.1
19P18.S.20.I	20	35	74	76.3
19P18.S.30.I	30	45	94	103.1
19P18.S.50.I	50	65	134	140.1

The standard level compensator G1/8" makes it possible to compensate for differences in height when the gripping system has to deal with objects of different heights, simplifies accurate positioning on vacuum systems, and makes it possible to position the suction cups on fragile items.

Standard level compensator G1/4" – internal and external spring

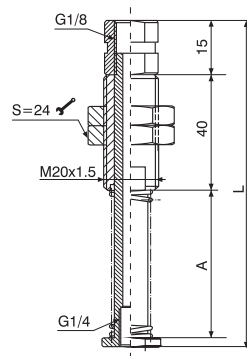

Code	A	L	Weight (gr.)
19P14.S.10.E	20	80	152.6
19P14.S.20.E	35	95	172.5
19P14.S.30.E	50	110	194
19P14.S.50.E	70	130	218.3

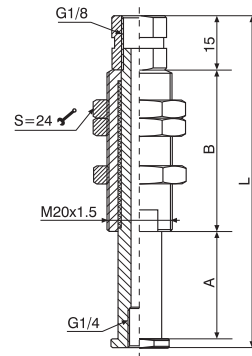

Code	A	B	L	Weight (gr.)
19P14.S.10.I	10	25	55	84.8
19P14.S.20.I	20	35	75	110.3
19P14.S.30.I	30	45	95	145.3
19P14.S.50.I	50	65	135	191.6

The standard level compensator G1/4" makes it possible to compensate for differences in height when the gripping system has to deal with objects of different heights, simplifies accurate positioning on vacuum systems, makes it possible to position the suction cups on fragile items.

► Anti-rotation level compensator G3/8" - internal spring

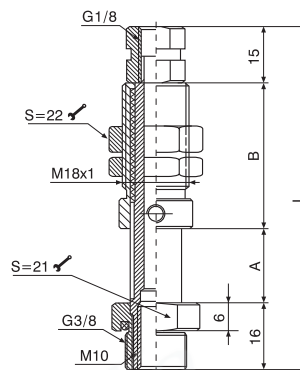

Code	A	B	L	Weight (gr.)
19P38.N.10.I	10	28	69	112.3
19P38.N.20.I	20	39	90	134.7
19P38.N.30.I	30	50	111	158.2
19P38.N.50.I	50	70	151	204.9

The anti-rotation level compensator G3/8" makes it possible to compensate for differences in height when the gripping system has to deal with objects of different heights, simplifies accurate positioning on vacuum systems, and makes it possible to position the suction cups on fragile items. The anti-rotation design makes it possible to use oval or rectangular suction cups.

LEVEL COMPENSATORS

► Standard level compensator G1/2"

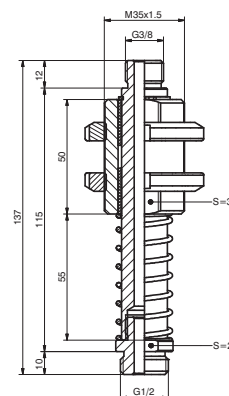

Code	Weight (gr.)
19P12.S.55.E	470 g

The standard level compensator G1/2" makes it possible to compensate for differences in height when the gripping system has to deal with objects of different heights, simplifies accurate positioning on vacuum systems, makes it possible to position the suction cups on fragile items.

► Sleeves for antirotation level compensators

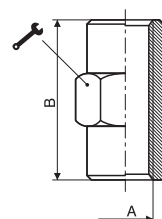

Code	A	B	Weight (gr.)
10338	G3/8"	23	34.9

► Sleeves for antirotation level compensators

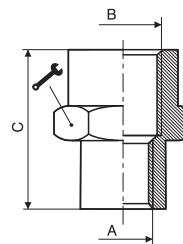

Code	A	B	C		Weight (gr.)
1061838	G1/8"	G3/8"	20	22	27.4
1061438	G1/4"	G3/8"	23	22	30.5
1063812	G3/8"	G1/2"	27.5	26	35.1

► Cylindrical nipples for compensators

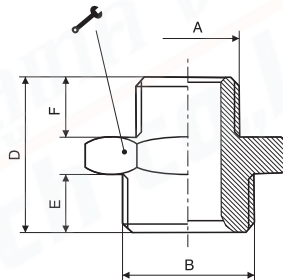

Code	A	B	D	E	F		Weight (gr.)
101M5M5	M5	M5	11.5	4	4	8	2.3
101M518	M5	G1/8"	14.5	6	4	14	8.4
1011818	G1/8"	G1/8"	16.5	6	6	14	9.2
1011814	G1/8"	G1/4"	19	8	6	17	14.6
1011838	G1/8"	G3/8"	20	9	6	19	19.7
1011414	G1/4"	G1/4"	21	8	8	17	15.7
1011438	G1/4"	G3/8"	22	9	8	19	22
1011412	G1/4"	G1/2"	23.5	10	8	24	36.5
1013838	G3/8"	G3/8"	23	9	9	19	24
1013812	G3/8"	G1/2"	24.5	10	9	24	38.1
1011212	G1/2"	G1/2"	25.5	10	10	24	40