

Mini solenoid valve 15 mm

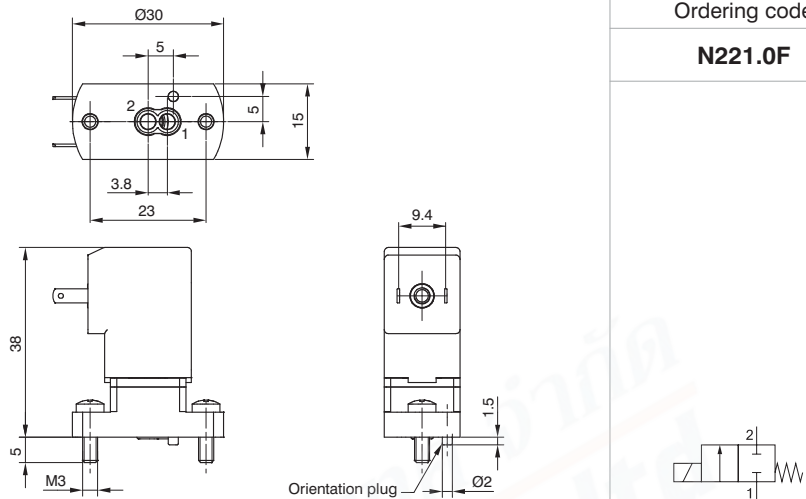

Ordering code
N221.0F

Technical characteristics	
Fluid	Unlubricated filtered air
Pressure (bar)	0 ... 6
Function	N.C.
Flow rate (Nl/m)	185
Operating voltage	24 VDC
Power	4 Watt
Class of insulation	F (155 °C)
IP Rating	IP65 (with connector) - IP00 (with Faston)
Temperature (°C)	-5 ... +50
Weight (gr.)	35.5

Connector

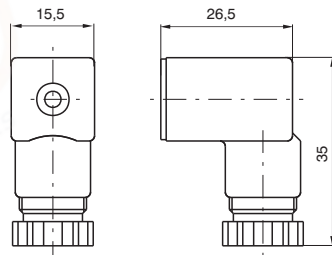

Ordering code
315.11.00

Weight 13 gr.

Closing plate

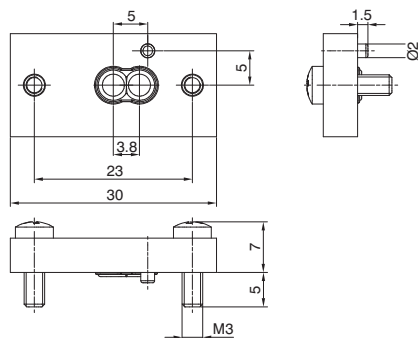

Ordering code
N221.00

Weight 7.5 gr.

VACUUM GENERATORS



Digital vacuum switch

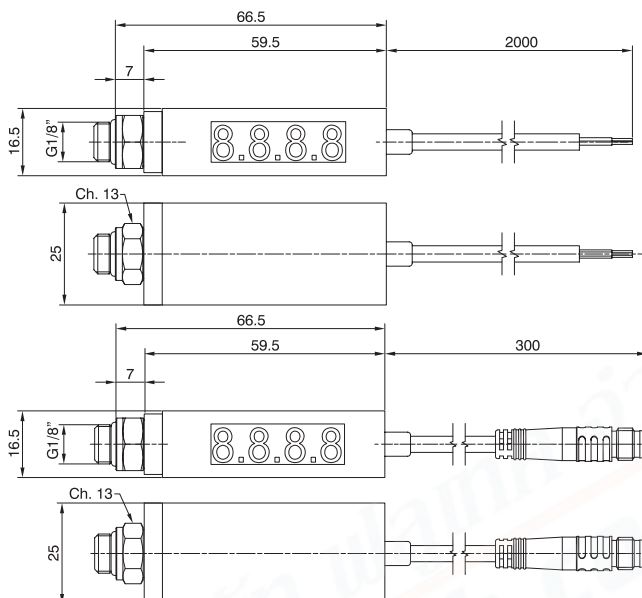

Ordering code	DS.30.C.C.F8.Ⓛ.Ⓞ
CABLE LENGTH	
Ⓛ	B=300 mm *
	D=2000 mm **
OPTIONS	
Ⓞ	0= Without connector
Ⓛ	2= With M8 4 Pin male connector
* only with M8 connector ** only without connector	

Technical features		
Working pressure range		-100.0 ... 100.0kPa
Regulation pressure range		-100.0 ... 100.0kPa
Maximum supported pressure		300 kPa
Allowed fluids		Air, non-corrosive gases, non-combustible gases
Pressure calibration sensitivity	kPa	0.1
	2 kgf/cm ²	0.001
	bar	0.001
	psi	0.01
	InHg	0.1
	mmHg	1
Supply voltage		From 12 to 24 VDC ± 10%
Current consumption		≤ 60mA
Digital output		PNP N.O. 2 outputs Maximum load current: 80mA Maximum supply voltage: 30VDC Voltage drop: ≤ 1V
Repeatability (Digital output)		± 0.2% Full Scale ± 1 digit
Digital output	Type of hysteresis	Fixed
	Hysteresis	0.003 bar
Response time		≤ 2,5 ms (anti-interference function: 24ms, 192ms and 768 ms selectable)
Protection from short circuit at output		Present
Display		Display with 3 1/2 digits (sampling 5 times per sec.)
Indicator precision		± 2% F. S. ± 1 digit (at ambient temperature of 25°C ± 3°C)
Indicator		LED green (output1) LED red (output2)
Ingress protection rating	IP Rating	IP40
	Ambient temperature	Operational: 0 ... 50°C, Storage: -20 ... 60°C (without ice or condensation)
	Ambient humidity	Operational/Storage: 35 ... 85% (without condensation)
	Supported voltage	1000VAC in 1-min. (between body and cable)
	Insulation resistance	50MΩ min. (at 500VDC, between body and cable)
	Vibration	Total amplitude 1.5mm. or 10G, 10Hz-55Hz-10Hz scanning for 1 minute, 2 hours in each direction of X, Y and Z
Impacts/shocks		980m/s ² (100G), 3 times in each direction of X, Y and Z
Temperature characteristics		± 2% Full Scale in a range between 0 ... 50°C
Type of connection		G1/8" (Swivel)
Electrical cable		Oil resistant cable
Weight		Approximately 67 gr. (with 2 metres of cable)

Output circuit wiring scheme

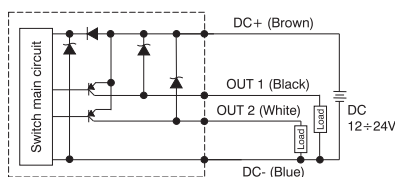

VACUUM GENERATORS

