



Direct-acting 2/2 or 3/2 way Rocker-Solenoid Valve with separating diaphragm

- For maximum chemical resistance requirements
- Compact design with 16 mm width and Cv ratings up to 0.058
- Proven reliability since 1993
- Flexible design for custom manifold assemblies
- High back pressure tightness, excellent cleanability and 100% duty cycle

Product variants described in the data sheet may differ from the product presentation and description.

Can be combined with

| | |
|--|--|
| | <p>Type 1054 ▶ Cable Plug</p> |
| | <p>Type 2505 ▶ Socket for 10 mm for Bürkert Solenoid Valves</p> |

Type description

Bürkert's unique miniature rocker solenoid valve is the pioneer of isolated mini valves suitable for laboratory, medical and analysis technology, that still set the standard! It is a highly reliable minimum volume valve that has low dead volume and is easy to purge. Boasting an inert isolating diaphragm between the actuator and body, it is operated via a rocker that separates the actuator from the fluid. Heat transfer between the actuator and the fluid is minimized due to the coil not having direct contact with the diaphragm. The valves can be manifold mounted and a simplified common wiring system is available if required. Special dead volume free designs are also obtainable on request.

Table of contents

| | |
|--|-----------|
| 1. General technical data | 3 |
| 2. Product versions | 4 |
| 3. Circuit functions | 4 |
| 4. Materials | 5 |
| 4.1. Chemical Resistance Chart – Bürkert resistApp..... | 5 |
| 4.2. Material specifications | 5 |
| 5. Dimensions | 6 |
| 5.1. Threaded port version (G 1/8, NPT 1/8) with rectangular plug (Type 2505)..... | 6 |
| 5.2. Threaded port version (UNF 1/4 ... 28) with cable plug (Type 1054) | 6 |
| 5.3. Tube connection with cable plug (Type 1054)..... | 7 |
| 5.4. Sub-base version with flying leads | 8 |
| 5.5. Bürkert sub-base interface 3-way (standard) | 8 |
| 5.6. Bürkert sub-base interface 2-way (standard) | 9 |
| 5.7. Bürkert sub-base interface 2-way (low dead volume) | 9 |
| 5.8. Manifolds in PEEK for Bürkert sub-base interface 2-way | 10 |
| 5.9. Manifolds in PPS for Bürkert sub-base interface 2-way | 11 |
| 5.10. Manifolds in aluminium for Bürkert sub-base interface 3-way (black anodized)..... | 12 |
| 5.11. Single manifolds in aluminium for Bürkert sub-base interface 3-way (black anodized)..... | 13 |
| Port connection M5 | 13 |
| Port connection G 1/8..... | 14 |
| 6. Performance specifications | 15 |
| 6.1. Internal volume | 15 |
| 6.2. Medium temperature..... | 15 |
| 7. Ordering information | 15 |
| 7.1. Bürkert eShop – Easy ordering and quick delivery..... | 15 |
| 7.2. Bürkert product filter..... | 16 |
| 7.3. Ordering chart..... | 16 |
| Standard valves | 16 |
| Valves with power reduction..... | 17 |
| 7.4. Ordering chart accessories..... | 18 |
| Manifolds in PEEK for Bürkert sub-base interface 2-way | 18 |
| Manifolds in PPS for Bürkert sub-base interface 2-way | 18 |
| Manifolds in aluminium for Bürkert sub-base interface 3-way (black anodized)..... | 18 |
| Single manifolds in aluminium for Bürkert sub-base interface 3-way (black anodized)..... | 18 |
| Cable plug Type 1054 and rectangular plug Type 2505 | 18 |

1. General technical data

| Product properties | |
|---------------------------------------|---|
| Dimensions | Detailed information can be found in chapter "5. Dimensions" on page 6. |
| Materials | |
| Fluid housing | PEEK, PVDF, PPS |
| Seal | FFKM, FKM, EPDM |
| Nominal operating mode ^{1.)} | 10 mio. switching cycles (according to laboratory endurance test with FKM and EPDM) |
| Internal volume ^{2.)} | Sub-base: starting at 44 µl G 1/8 and NPT 1/8: starting at 100 µl UNF 1/4...28: starting at 25 µl Tube connection: starting at 33 µl < 10 µl available on request |
| Orifice | DN 0.8...DN 1.6 |
| Electrical data | |
| Operating voltage | 12/24 V DC, 24 V UC, other voltages are available on request |
| Voltage tolerance | ± 10 % |
| Power consumption | 3.4 W |
| Duty cycle | 100 % continuous rating Manifold mounting: If medium or ambient temperatures are above +40 °C: intermittent operation 40 % (minimum 10 min) |
| Performance data | |
| Response times ^{3.)} | Open: ca. 25 ms (Pressure rise 0...10%) Closing: ca. 25 ms (Pressure drop 100...90 %) |
| Medium data | |
| Operating medium | Resistant to neutral and aggressive liquids and gases |
| Medium temperature ^{4.)} | - 10...55 °C |
| Approvals and certificates | |
| Protection class | IP65 with flying leads and cable plug Type 1054 IP30 with rectangular plug Type 2505 |
| Product connections | |
| Port connection | Bürkert sub-base (16×27 mm) G 1/8 NPT 1/8 UNF 1/4...28 Tube connection |
| Electrical connection ^{5.)} | Cable plug Type 1054 Two FEP-leads 0.2 mm ² , length 500 mm Rectangular cable plug, Type 2505 |
| Environment and installation | |
| Installation | As required, preferably with actuator upright |
| Ambient temperature (max.) | 55 °C |

1.) The life expectancy depends on medium, temperature, pressure, seal material, individual application conditions.

2.) The internal volume can vary depending on the housing. For further information see "6.1. Internal volume" on page 15.

3.) Measured at valve outlet at 2 bar and +20 °C acc. to DIN ISO 12238:2001



4.) Temperature may vary depending on orifice and seal material. For further information see "6.2. Medium temperature" on page 15.

5.) Other electric connectors and other cable lengths upon request.

2. Product versions

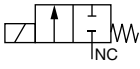
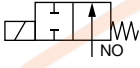

3. Circuit functions

| Circuit functions | Description |
|---|---|
|  | <p>Type: A, solenoid valve 2/2 way Direct-acting Normally closed</p> |
|  | <p>Type: B, solenoid valve 2/2 way Direct-acting Normally open</p> |
|  | <p>Type: T, solenoid valve 3/2 way Direct-acting Flow direction optional Universal</p> |

DTS 1000010906 EN Version: U Status: RL (released | freigegeben | validé) printed: 25.02.2021

4. Materials

4.1. Chemical Resistance Chart – Bürkert resistApp



Bürkert resistApp – Chemical Resistance Chart

You want to ensure the reliability and durability of the materials in your individual application case? Verify your combination of medium and materials on our website or in our resistApp.

[Start Chemical Resistance Check](#)

4.2. Material specifications

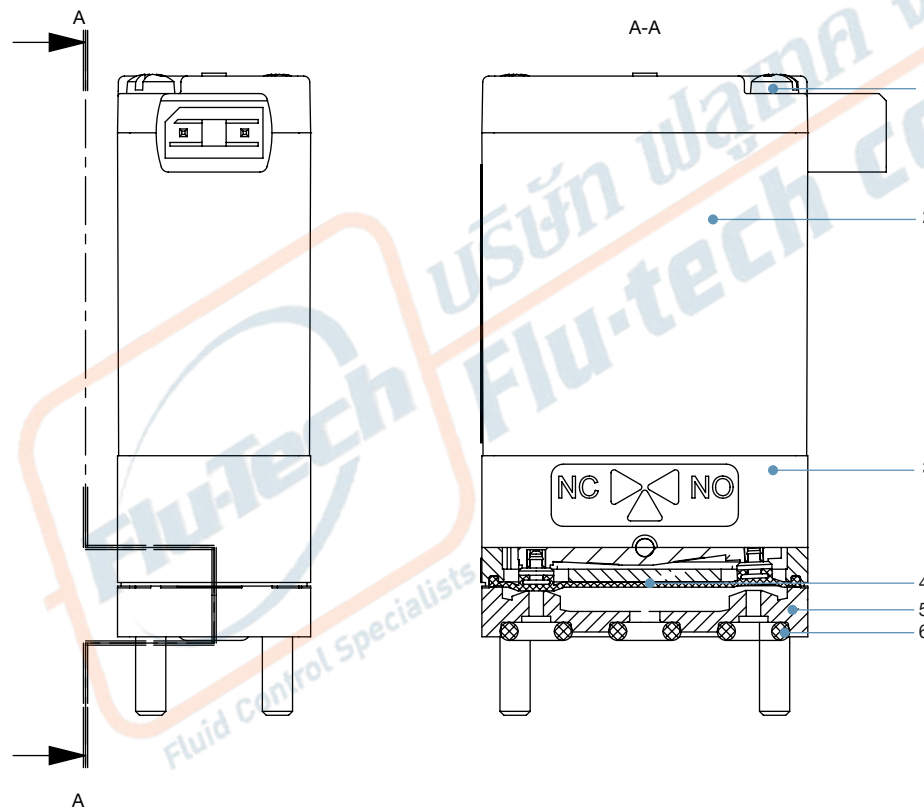

| No. | Element | Material |
|-----|--------------------------------|-----------------|
| 1 | Rounded head screw M2.5 | A2 |
| 2 | Coil | Epoxy |
| 3 | Actuator housing | PPS |
| 4 | Diaphragm (medium contact) | FFKM, FKM, EPDM |
| 5 | Fluid housing (medium contact) | PPS, PVDF, PEEK |
| 6 | Flange seal (medium contact) | FFKM, FKM, EPDM |

DTS 1000010906 EN Version: U Status: RL (released | freigegeben | valide) printed: 25.02.2021

5. Dimensions

5.1. Threaded port version (G 1/8, NPT 1/8) with rectangular plug (Type 2505)

Note:

- Dimensions in mm
- Further versions on request

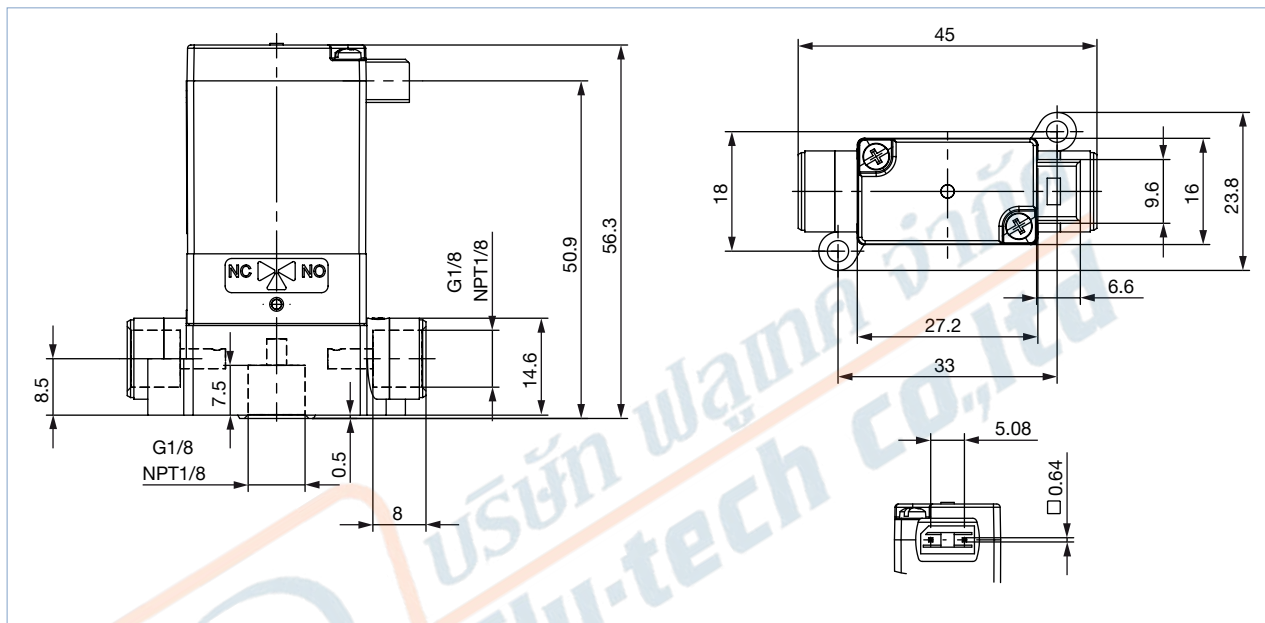

5.2. Threaded port version (UNF 1/4 ... 28) with cable plug (Type 1054)

Note:

- Dimensions in mm
- Further versions on request

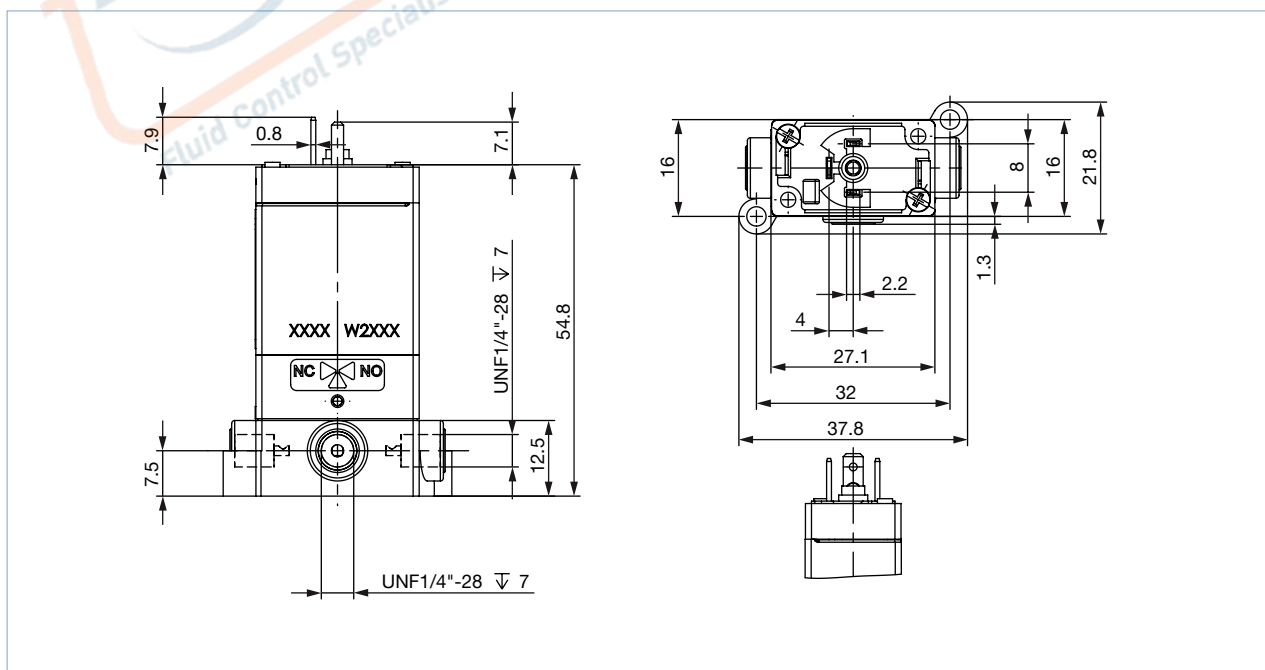

DTS 1000010906 EN Version: U Status: RL (released | freigegeben | valide) printed: 25.02.2021

5.3. Tube connection with cable plug (Type 1054)

Note:

- Dimensions in mm
- Further versions on request

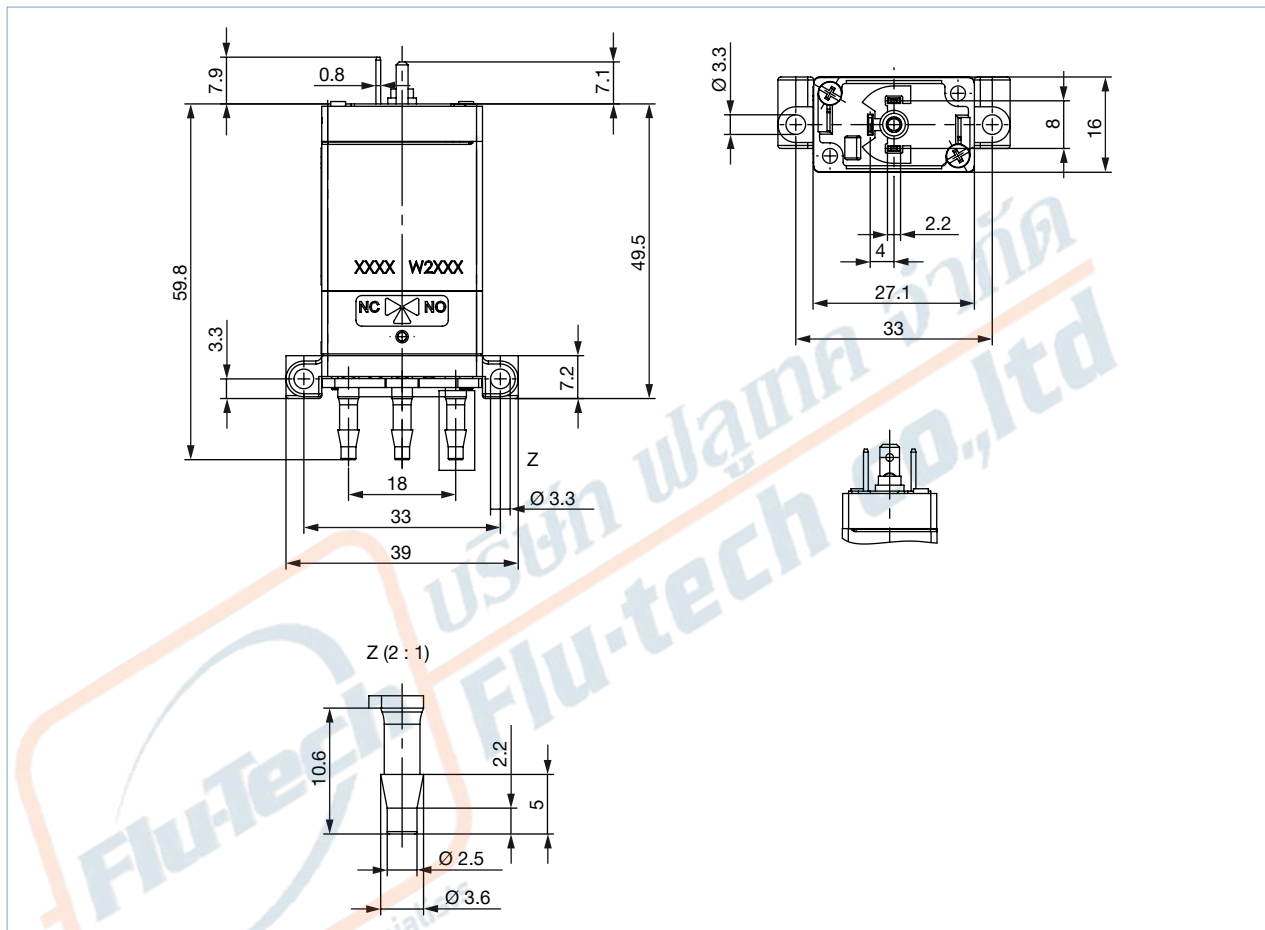

DTS 1000010906 EN Version: RL (released | freigegeben | valide) printed: 25.02.2021

5.4. Sub-base version with flying leads

Note:

- Dimensions in mm
- Other screw length on request
- Self-tapping screws on request

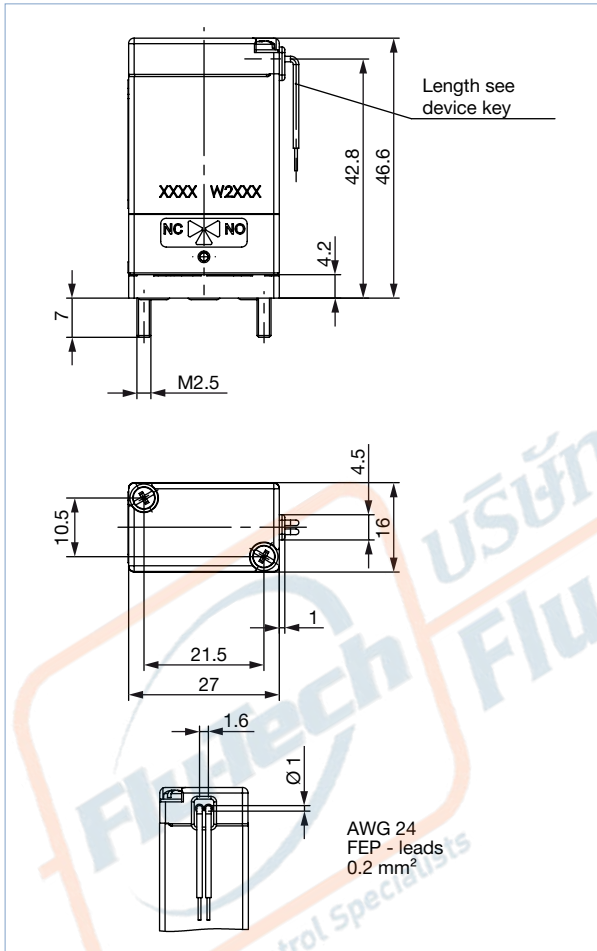

| Classification of fluid connections |
|---|
| WWA (circuit function: Type A) 2/2 way, direct-acting, normally closed energized at NC connection |
| WWB (circuit function: Type B) 2/2 way, direct-acting, normally opened energized at NO connection |
| WWT (circuit function: Type T) 3/2 way, direct-acting, flow direction optional, universal |
| See chapter "3. Circuit functions" on page 4 |

5.5. Bürkert sub-base interface 3-way (standard)

Note:

Dimensions in mm

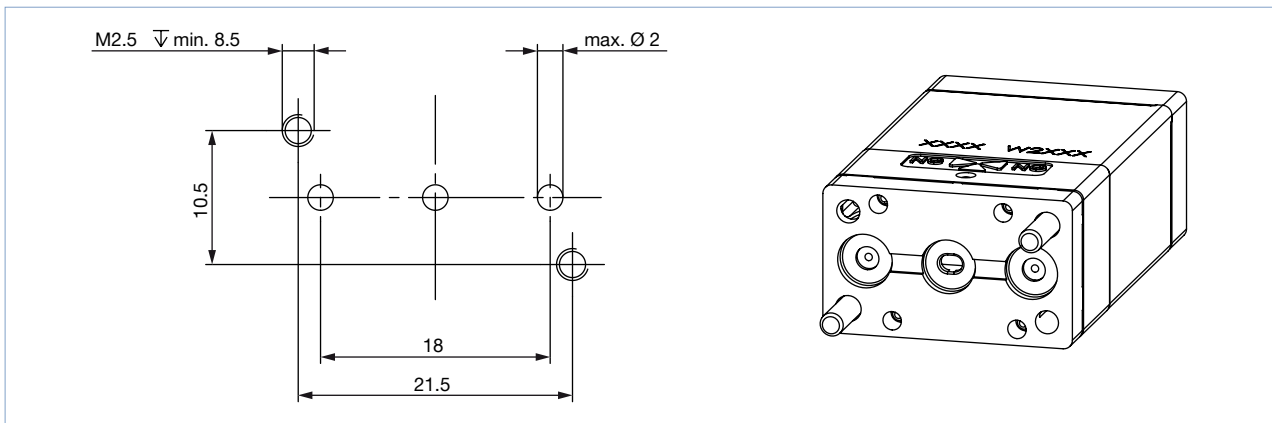

DTS 1000010906 EN Version: U Status: RL (released | freigegeben | valide) printed: 25.02.2021

5.6. Bürkert sub-base interface 2-way (standard)

Note:

Dimensions in mm

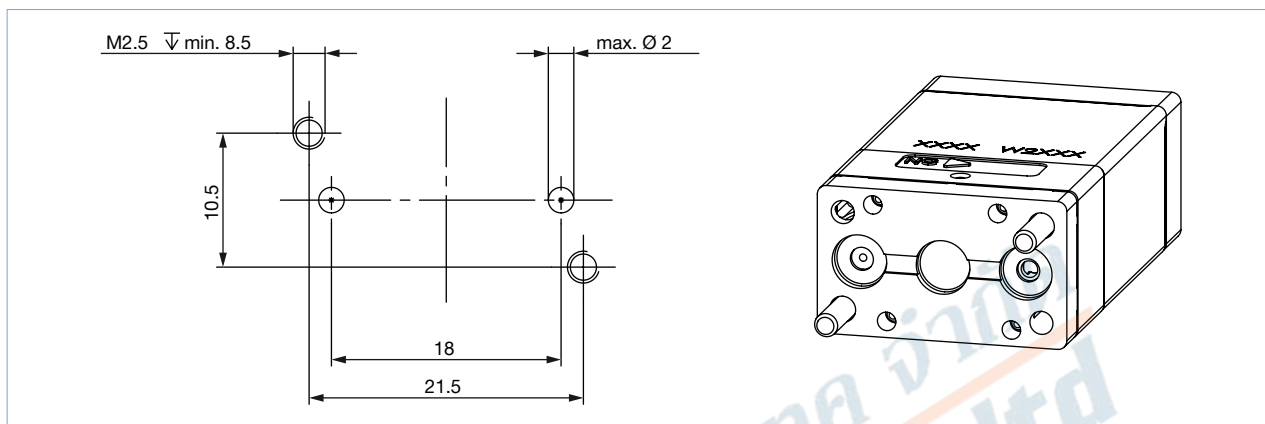

5.7. Bürkert sub-base interface 2-way (low dead volume)

Note:

- Dimensions in mm
- Available on request

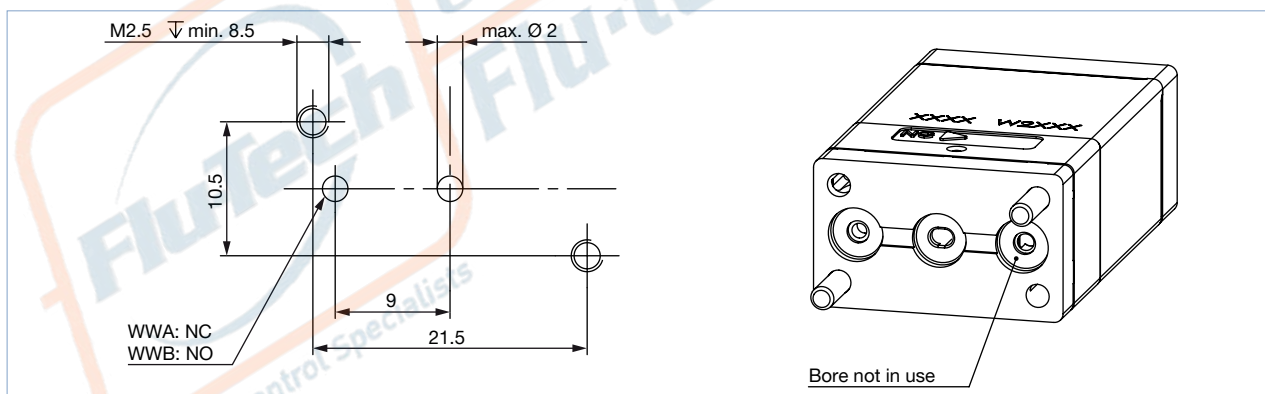

DTS 1000010906 EN Version: U Status: RL (released | freigegeben | valide) printed: 25.02.2021

5.8. Manifolds in PEEK for Bürkert sub-base interface 2-way

Note:

- Dimensions in mm
- Port connection UNF 1/4...28
- Consider the screw protrusion!
- Further versions on request

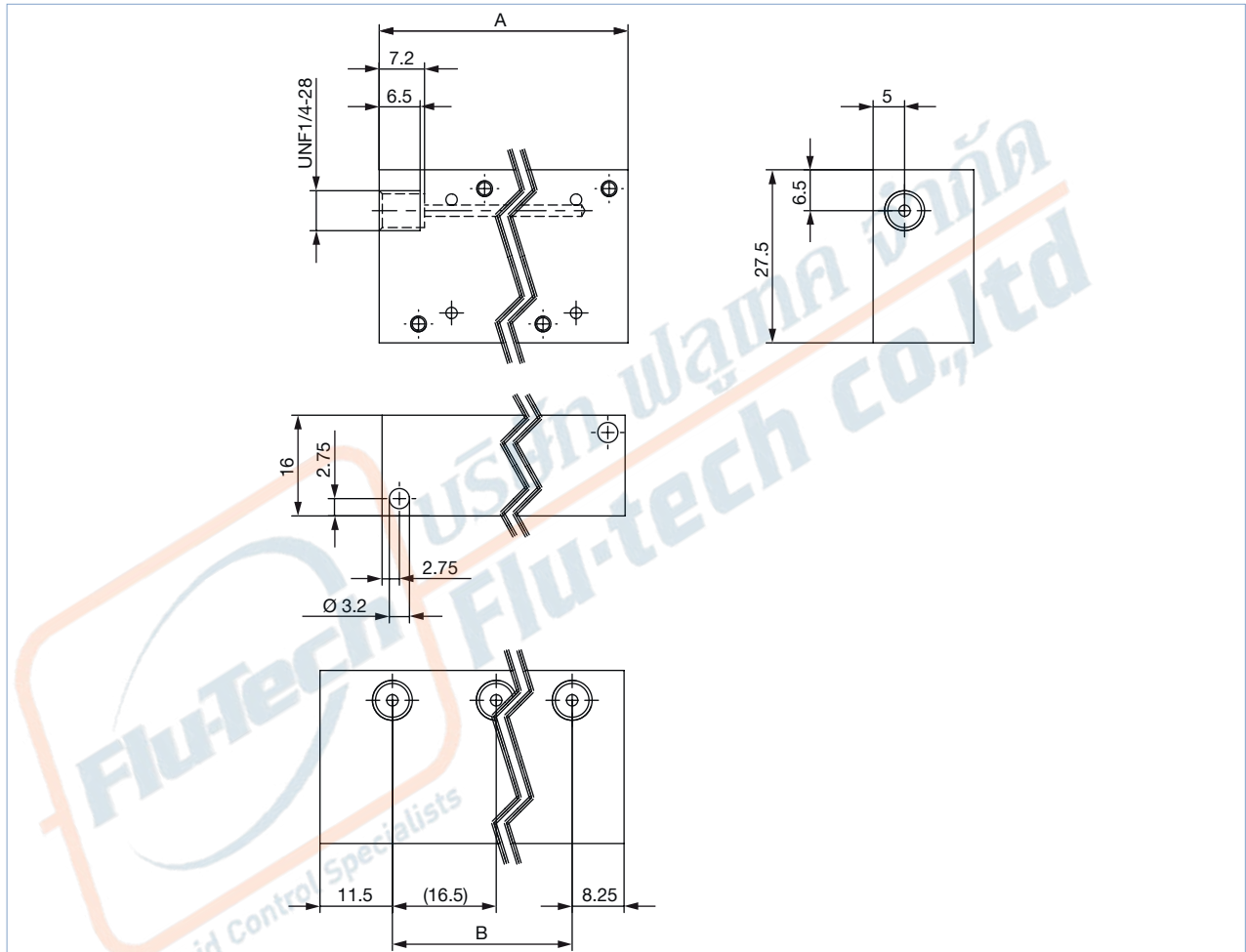

| Manifold | A | B | n | Article no. |
|----------|--------|-------|---|-------------|
| 2-fold | 36.25 | 16.5 | 2 | 651506 |
| 3-fold | 52.75 | 33 | 3 | 651510 |
| 4-fold | 69.25 | 49.5 | 4 | 651507 |
| 5-fold | 85.75 | 66 | 5 | 651508 |
| 6-fold | 102.25 | 82.5 | 6 | 651509 |
| 7-fold | 118.75 | 99 | 7 | 651521 |
| 8-fold | 135.25 | 115.5 | 8 | 651522 |

DTS 1000010906 EN Version: U Status: RL (released | freigegeben | valide) printed: 25.02.2021

5.9. Manifolds in PPS for Bürkert sub-base interface 2-way

Note:

- Dimensions in mm
- Port connection G 1/8
- Consider the screw protrusion!
- Further versions on request

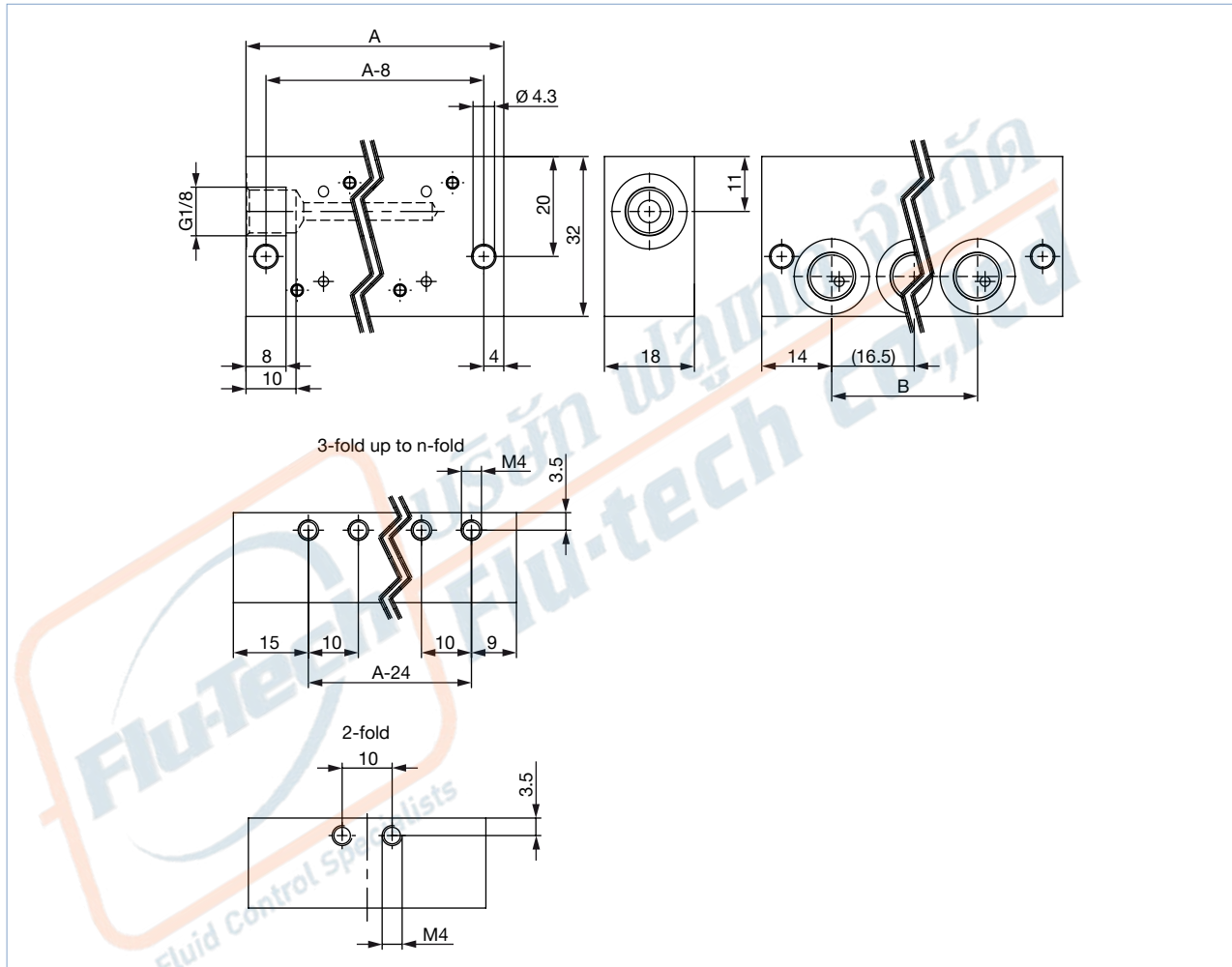

| Manifold | A | B | n | Article no. |
|----------|-------|-------|----|-------------|
| 2-fold | 47.5 | 16.5 | 2 | 675628 |
| 3-fold | 64 | 33 | 3 | 675629 |
| 4-fold | 80.5 | 49.5 | 4 | 675630 |
| 5-fold | 97 | 66 | 5 | 675631 |
| 6-fold | 113.5 | 82.5 | 6 | 675632 |
| 7-fold | 130 | 99 | 7 | 675633 |
| 8-fold | 146.5 | 115.5 | 8 | 675634 |
| 9-fold | 163 | 132 | 9 | 675635 |
| 10-fold | 179.5 | 148.5 | 10 | 675636 |

5.10. Manifolds in aluminium for Bürkert sub-base interface 3-way (black anodized)

Note:

- Dimensions in mm
- Port connection 1: G 1/8
- Port connection 2: M5
- Consider the screw protrusion!
- Further versions on request

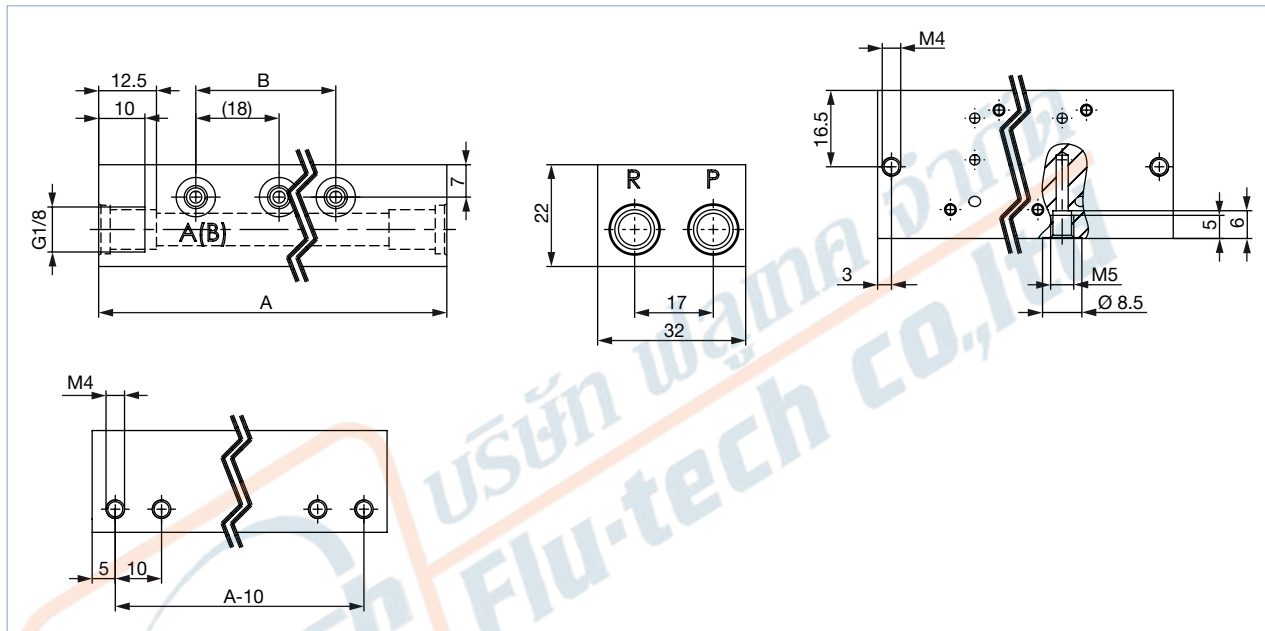

| Manifold | A | B | n | Article no. |
|----------|-----|-----|----|-------------|
| 2-fold | 63 | 18 | 2 | 658695 |
| 3-fold | 81 | 36 | 3 | 658696 |
| 4-fold | 99 | 54 | 4 | 658697 |
| 5-fold | 117 | 72 | 5 | 658698 |
| 6-fold | 135 | 90 | 6 | 658699 |
| 8-fold | 171 | 126 | 8 | 658700 |
| 10-fold | 207 | 162 | 10 | 658701 |
| 12-fold | 243 | 198 | 12 | 658703 |

DTS 1000010906 EN Version: U Status: RL (released | freigegeben | valide) printed: 25.02.2021

5.11. Single manifolds in aluminium for Bürkert sub-base interface 3-way (black anodized)

Port connection M5

Note:

- Dimensions in mm
- Consider the screw protrusion!
- Further versions on request

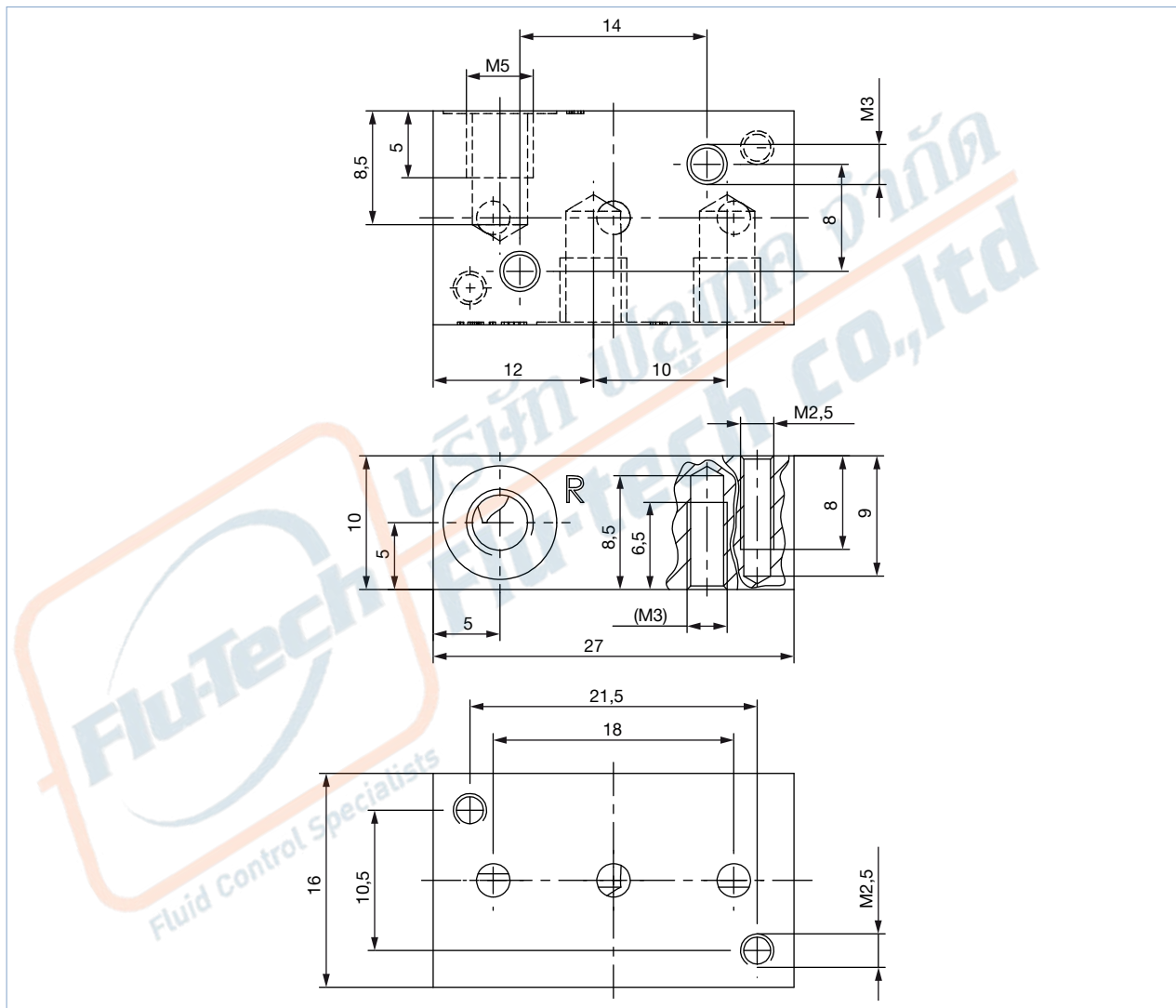

| Manifold | Article no. |
|----------|-------------|
| 1-fold | 623873 |

DTS 1000010906 EN Version: U Status: RL (released | freigegeben | valide) printed: 25.02.2021

Port connection G 1/8

Note:

- Dimensions in mm
- Consider the screw protrusion!
- Further versions on request

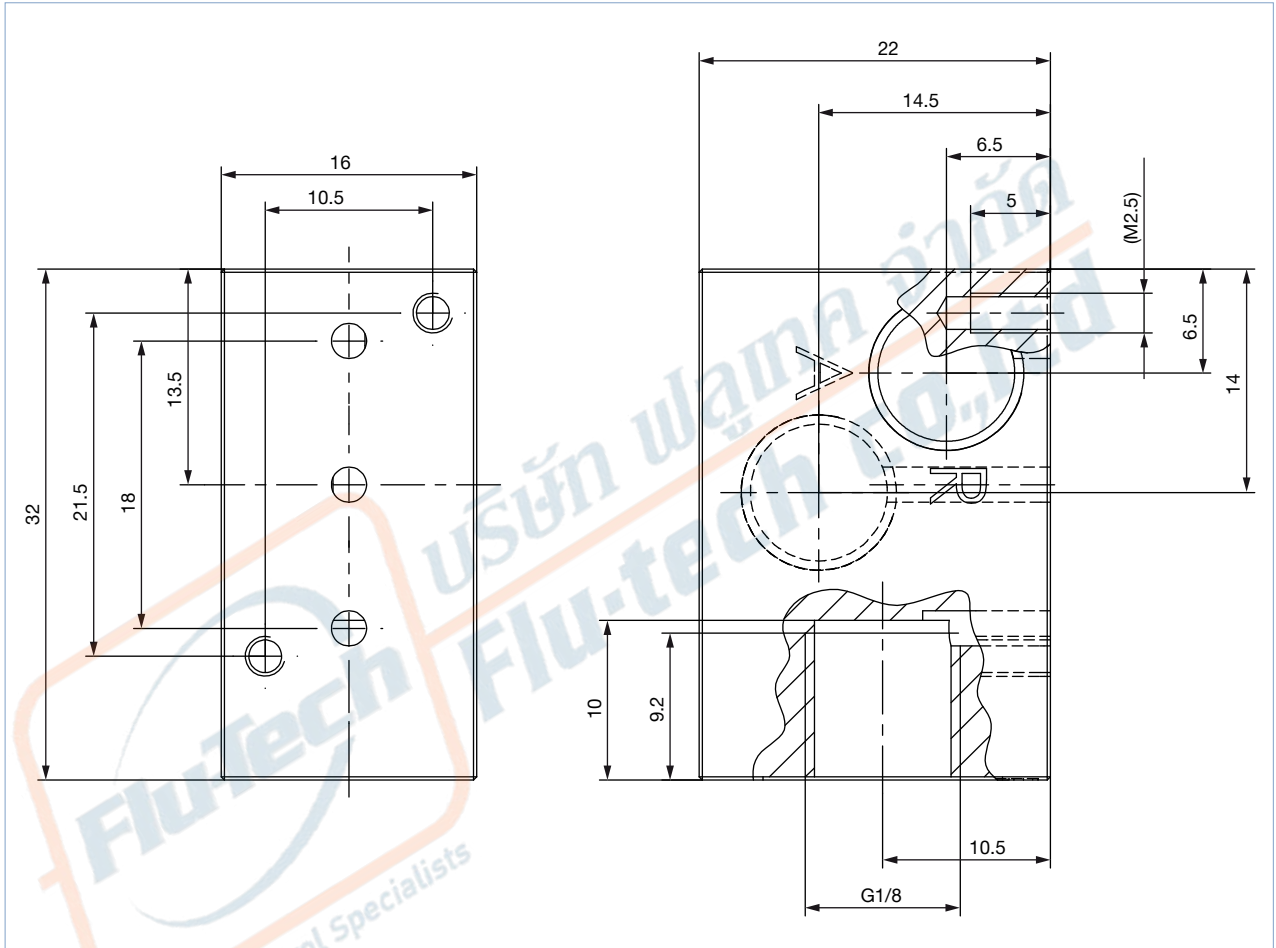

| Manifold | Article no. |
|----------|-------------|
| 1-fold | 634917 |

6. Performance specifications

6.1. Internal volume

Note:

The internal volume is depending on fluid housing.

| Body | 2-way low dead volume | | 2-way | | 3-way | |
|-----------------|-----------------------|--------|---------------|--------|---------------|--------|
| | Fluid chamber | Total | Fluid chamber | Total | Fluid chamber | Total |
| Sub-base | 44 µl | 54 µl | 97 µl | 106 µl | 90 µl | 106 µl |
| G 1/8, NPT 1/8 | – | – | 100 µl | 211 µl | 92 µl | 229 µl |
| UNF 1/4 ...28 | 25 µl | 69 µl | 55 µl | 79 µl | 54 µl | 95 µl |
| Tube connection | 33 µl | 112 µl | 62 µl | 142 µl | 69 µl | 185 µl |

6.2. Medium temperature

Note:

The permissible medium temperature depends on the material and the nominal size.

| Description | Orifice | Seal material | Temperature range |
|--|---------------------------------|---------------|-------------------|
| Medium temperature | DN 0.8 | FFKM | +5 °C...+50 °C |
| | DN 0.8 | FKM | 0 °C...+50 °C |
| | DN 0.8 | EPDM | -5 °C...+50 °C |
| | DN 1.2 and DN 1.6 | FFKM | +10 °C...+50 °C |
| | DN 1.2 and DN 1.6 | FKM | +5 °C...+50 °C |
| | DN 1.2 and DN 1.6 | EPDM | 0 °C...+50 °C |
| Medium temperature with limitation on switching time and life expectancy | DN 0.8 | FFKM | 0 °C...+50 °C |
| | DN 0.8 | FKM | -5 °C...+55 °C |
| | DN 0.8 | EPDM | -10 °C...+50 °C |
| | DN 1.2 and DN 1.6 | FFKM | +5 °C...+50 °C |
| | DN 1.2 and DN 1.6 ¹⁾ | FKM | 0 °C...+55 °C |
| | DN 1.2 and DN 1.6 | EPDM | -5 °C...+50 °C |

1.) Upon request up to -15 °C available

7. Ordering information

7.1. Bürkert eShop – Easy ordering and quick delivery



Bürkert eShop – Easy ordering and fast delivery

You want to find your desired Bürkert product or spare part quickly and order directly? Our online shop is available for you 24/7. Sign up and enjoy all the benefits.

[Order online now](#)

7.2. Bürkert product filter



Bürkert product filter – Get quickly to the right product

You want to select products comfortably based on your technical requirements? Use the Bürkert product filter and find suitable articles for your application quickly and easily.

Try out our product filter

7.3. Ordering chart

Standard valves

Note:

- Overpressure with respect to atmospheric pressure
- On request different pressure ranges available

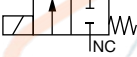
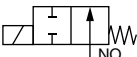
| Circuit function | Orifice | Port connection | K _v value water | C _v value | Q _{Nn} value air | Pressure range | Seal material | Fluid housing material | Electrical connection | Voltage/Frequency | Article no. |
|--|----------|-----------------|----------------------------|----------------------|---------------------------|---------------------|------------------|------------------------|-----------------------|-------------------|-------------|
| | [mm] | | [m ³ /h] | [gal/min] | [l/min] | | | | | [V/Hz] | |
| A, solenoid valve 2/2 way Direct-acting Normally closed  | 0.8 | Sub-base | 0.015 | 0.017 | 16 | 0...6 | FFKM | PEEK | Leads, 0.5 m | 24/DC | 276699 ☒ |
| | | | | | | | | | Leads, 0.5 m | 24/DC | 264327 ☒ |
| | | | | | | | | | Rectangular plug | 24/DC | 276701 ☒ |
| | 1.2 | Sub-base | 0.03 | 0.035 | 32 | 0...5 | FFKM | PEEK | Leads, 0.5 m | 24/DC | 276703 ☒ |
| | | | | | | | | | Rectangular plug | 24/DC | 276710 ☒ |
| | | | | | | | | | Leads, 0.5 m | 24/DC | 276718 ☒ |
| | UNF ¼-28 | 0.025 | 0.029 | 27 | 0...5 | FFKM | PEEK | Cable plug | 24/DC | 276728 ☒ | |
| | | | | | | | | Leads, 0.5 m | 12/DC | 244706 ☒ | |
| | | | | | | | | | 24/DC | 280858 ☒ | |
| | 1.6 | G ½ | 0.05 | 0.058 | 54 | 0...2 | FFKM | PVDF | Leads, 0.5 m | 24/DC | 120677 ☒ |
| | | | | | | | | | Rectangular plug | 24/DC | 272153 ☒ |
| | | NPT ½ | 0.05 | 0.058 | 54 | 0...2 | FFKM | PVDF | Rectangular plug | 24/DC | 272160 ☒ |
| | | | | | | | | | Leads, 0.5 m | 24/DC | 463551 ☒ |
| | | UNF ¼-28 | 0.03 | 0.035 | 33 | 0...2 | FFKM | PEEK | Rectangular plug | 24/DC | 262460 ☒ |
| Cable plug | | | | | | | | | 24/DC | 207675 ☒ | |
| Sub-base | 0.045 | 0.052 | 49 | 0...2 | FFKM | PVDF | Leads, 0.5 m | 24/DC | 276738 ☒ | | |
| | | | | | | | Leads, 0.5 m | 24/DC | 242451 ☒ | | |
| | | | | | | | Rectangular plug | 24/DC | 273398 ☒ | | |
| | | | | | | | Rectangular plug | 12/DC | 276746 ☒ | | |
| Tube connection | 0.045 | 0.052 | 49 | 0...2 ¹⁾ | FFKM | PVDF | Leads, 0.5 m | 24/DC | 455390 ☒ | | |
| | | | | | | | Rectangular plug | 24/DC | 272154 ☒ | | |
| B, solenoid valve 2/2 way Direct-acting Normally opened  | 1.6 | G ½ | 0.05 | 0.058 | 54 | 0...2 | FFKM | PVDF | Leads, 0.5 m | 24/DC | 120678 ☒ |
| | | Tube connection | 0.045 | 0.052 | 49 | 0...2 ¹⁾ | FFKM | PVDF | Leads, 0.5 m | 24/DC | 120684 ☒ |
| | | Sub-base | 0.045 | 0.052 | 49 | 0...2 | EPDM | PPS | Rectangular plug | 24/DC | 276747 ☒ |

1.) Low dead-volume version, maximum back pressure 1 bar

DTS 1000010906 EN Version: U Status: RL (released | freigegeben | valide) printed: 25.02.2021



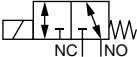

| Circuit function | Orifice | Port connection | K _v value water | C _v value | Q _{Nn} value air | Pressure range | Seal material | Fluid housing material | Electrical connection | Voltage/Frequency | Article no. |
|---|---------|-----------------|----------------------------|----------------------|---------------------------|----------------|------------------|------------------------|-----------------------|-------------------|-------------|
| | [mm] | | [m ³ /h] | [gal/min] | [l/min] | | | | | [V/Hz] | |
| T, solenoid valve 3/2 way Direct-acting Flow direction optional Universal  | 0.8 | Sub-base | 0.015 | 0.017 | 16 | 0...6 | FFKM | PEEK | Leads, 0.5 m | 24/DC | 276748 ☒ |
| | | | | | | | FKM | PPS | Rectangular plug | 24/DC | 276749 ☒ |
| | | | | | | | EPDM | PPS | Rectangular plug | 24/DC | 276750 ☒ |
| | 1.2 | Sub-base | 0.03 | 0.035 | 32 | 0...5 | FFKM | PEEK | Leads, 0.5 m | 24/DC | 276753 ☒ |
| | | | | | | | | | Rectangular plug | 24/DC | 276754 ☒ |
| | | | | | | | FKM | PPS | Leads, 0.5 m | 24/DC | 276756 ☒ |
| | | | | | | | EPDM | PPS | Rectangular plug | 24/DC | 276758 ☒ |
| | | | | | | | FFKM | PEEK | Leads, 0.5 m | 12/DC | 244696 ☒ |
| | | | | | | | | | Rectangular plug | 24/DC | 297064 ☒ |
| | | | Cable plug | 24/DC | 269045 ☒ | | | | | | |
| | 1.6 | G 1/8 | 0.05 | 0.058 | 54 | 0...2 | FFKM | PVDF | Leads, 0.5 m | 24/DC | 120679 ☒ |
| | | | | | | | | | Rectangular plug | 24/DC | 272156 ☒ |
| | | NPT 1/8 | 0.05 | 0.058 | 54 | 0...2 | FFKM | PVDF | Leads, 0.5 m | 24/DC | 121781 ☒ |
| | | | | | | | | | | | |
| | | UNF 1/4 - 28 | 0.03 | 0.035 | 33 | 0...2 | FFKM | PEEK | Leads, 0.5 m | 24/DC | 464968 ☒ |
| | | | | | | | | | Rectangular plug | 24/DC | 262461 ☒ |
| | | | | | | | | | Cable plug | 24/DC | 280172 ☒ |
| | | Sub-base | 0.045 | 0.052 | 49 | 0...2 | FFKM | PVDF | Rectangular plug | 24/DC | 273853 ☒ |
| | | | | | | | | Leads, 0.5 m | 24/DC | 460264 ☒ | |
| FKM | PPS | | | | | | Rectangular plug | 24/DC | 271604 ☒ | | |
| EPDM | PPS | | | | | | Rectangular plug | 24/DC | 276759 ☒ | | |
| Tube connection | 0.045 | 0.052 | 49 | 0...2 | FFKM | PVDF | Leads, 0.5 m | 24/DC | 120685 ☒ | | |
| | | | | | | | Rectangular plug | 24/DC | 272157 ☒ | | |

Valves with power reduction

Note:

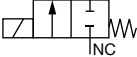
After approx. 500 ms, the nominal power is automatically reduced from 4 W to 1 W.

| Circuit function | Orifice | Port connection | K _v value water | C _v value | Q _{Nn} value air | Pressure range | Seal material | Fluid housing material | Electrical connection | Voltage/Frequency | Article no. |
|---|---------|-----------------|----------------------------|----------------------|---------------------------|----------------|---------------|------------------------|-----------------------|-------------------|-------------|
| | [mm] | | [m ³ /h] | [gal/min] | [l/min] | | | | | [V/Hz] | |
| A, solenoid valve 2/2 way Direct-acting Normally closed  | 1.2 | Sub-base | 0.03 | 0.035 | 32 | 0...5 | FKM | PPS | Rectangular plug | 24/DC | 357227 ☒ |
| | 1.6 | UNF 1/4 - 28 | 0.03 | 0.035 | 33 | 0...2 | FFKM | PEEK | Rectangular plug | 24/DC | 357229 ☒ |
| T, solenoid valve 3/2 way Direct-acting Flow direction optional Universal  | 1.2 | Sub-base | 0.03 | 0.035 | 32 | 0...5 | FKM | PPS | Rectangular plug | 24/DC | 357230 ☒ |
| | 1.6 | UNF 1/4 - 28 | 0.03 | 0.035 | 33 | 0...2 | FFKM | PEEK | Rectangular plug | 24/DC | 357233 ☒ |

7.4. Ordering chart accessories

Manifolds in PEEK for Bürkert sub-base interface 2-way

Note:

Detailed order information can be found in chapter [“5.8. Manifolds in PEEK for Bürkert sub-base interface 2-way”](#) on page 10.

Manifolds in PPS for Bürkert sub-base interface 2-way

Note:

Detailed order information can be found in chapter [“5.9. Manifolds in PPS for Bürkert sub-base interface 2-way”](#) on page 11.

Manifolds in aluminium for Bürkert sub-base interface 3-way (black anodized)

Note:

Detailed order information can be found in chapter [“5.10. Manifolds in aluminium for Bürkert sub-base interface 3-way \(black anodized\)”](#) on page 12.

Single manifolds in aluminium for Bürkert sub-base interface 3-way (black anodized)









Note:

Detailed order information can be found in chapter [“5.11. Single manifolds in aluminium for Bürkert sub-base interface 3-way \(black anodized\)”](#) on page 13.

Cable plug Type 1054 and rectangular plug Type 2505

Note:

For further versions see datasheet [Type 2505](#) ▶.

| Accessories | Description | Article no. |
|---|---|--|
|  | Cable plug Type 1054 (without cable) | 006699  |
|  | Cable plug Type 1054 with 3 m cable | 413552  |
|  | Rectangular plug Type 2505 with 300 mm leads, 2 pin | 262346  |
|  | Rectangular plug Type 2505 with 3 m cable, 2 pin | 252572  |